

FILTER NOZZLE + FIXING NUT N

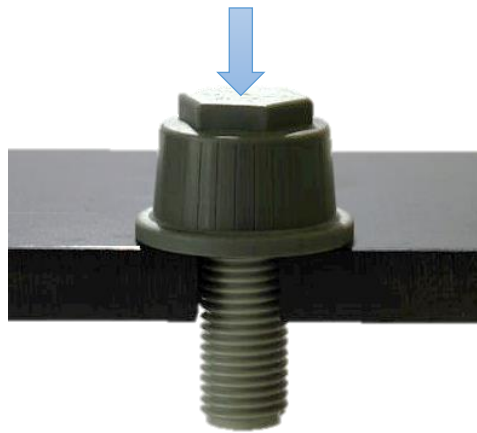

Insert the Nozzle into the hole from the top side of the plate and block it



*Check holes in the plate!  
Make sure the hole is suitable for the Nozzle's thread*



Screw the nut from the bottom and keep the nozzle blocked

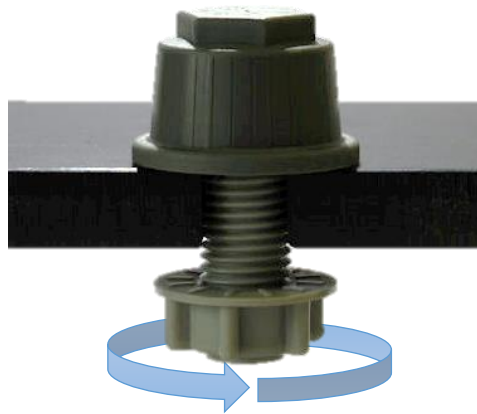

*Check plate thickness!  
Make sure the thread will be long enough*



Screw the Nozzle from the top and keep the nut blocked

*Torque setting 5.0 Nm  
Screwing speed less than 400 rpm*

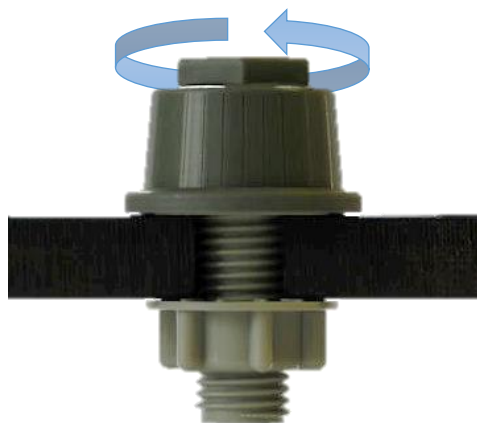

*Check the assembly!  
The Nozzle will not have to move and have to join perfectly with the plate*

SUGGESTED DEVICES

CHTW TORQUE SCREWDRIVER  
CHTC TORQUE SCREWDRIVER

